

*PCI-E 1X Slot*  
*Top Side 正面*

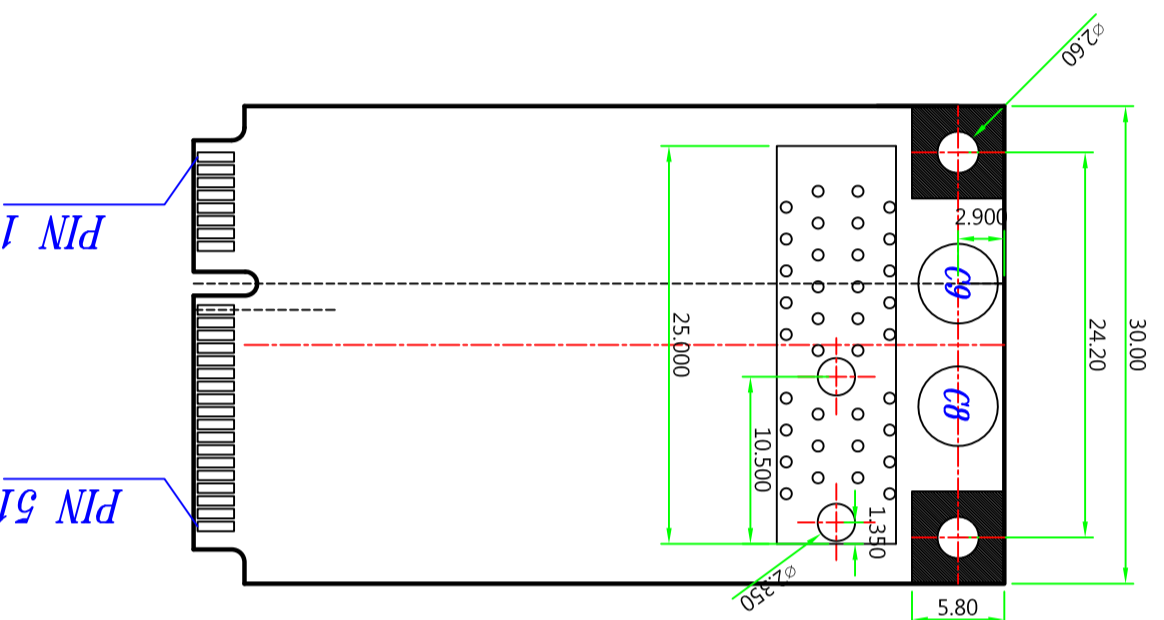

*Mini PCI-E Card*  
*Top Side 正面*

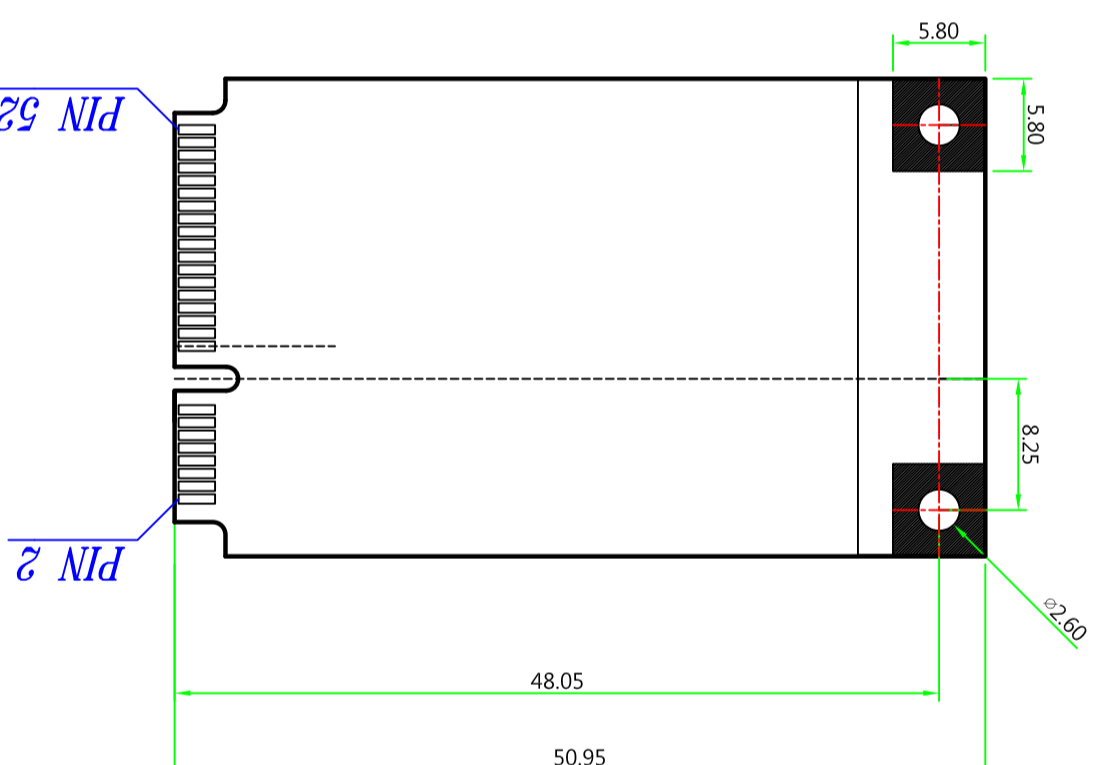

*Mini PCI-E Card*  
*Bottom Side 背面*

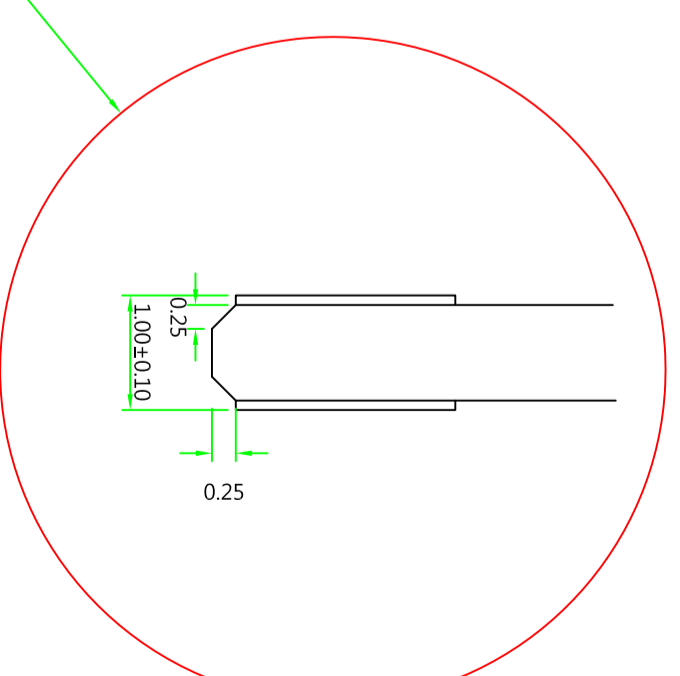

*Mini PCI-E Card*  
*Flank Side 側面*

2 Layer Daughter board PCB thickness MAX 1.0 mm

APPROVED:	— TOLERANCES —		UNIT:	TITLE :	SHEET
ENGINEER:	General	Angles	mm	Mini PCI-E to PCI-E 1X	1/1
CHECKED:	30~ ±0.25	0° ±3°	SCALE:	DRAWING NUMBER:	SIZE
DRAWN:	10~30 ±0.20	0.0° ±2°	1:1	A-G-804-PCBL	A4
	5~10 ±0.15			Date	REV.
	0~5 ±0.10			2008/Mdy/06th	A/0



Aeneas Electronics