

PCI-E to Mini PCI-E Adapter

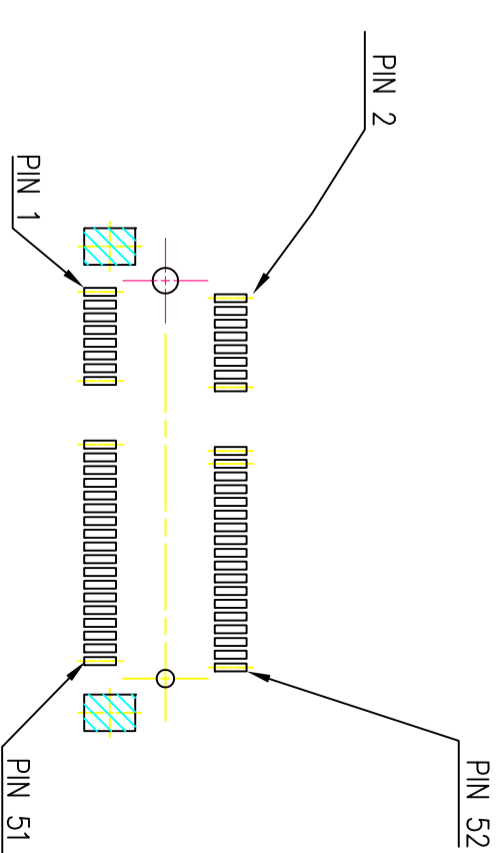

Recommended P.C.Board Layout.
FOR STAND OFF TYPE

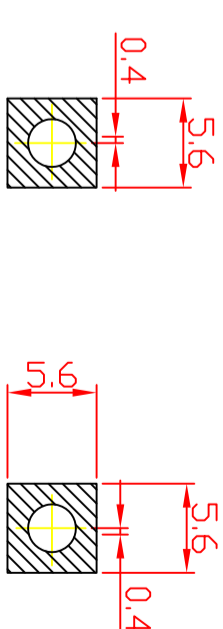
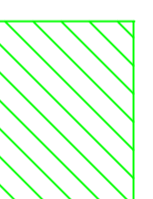
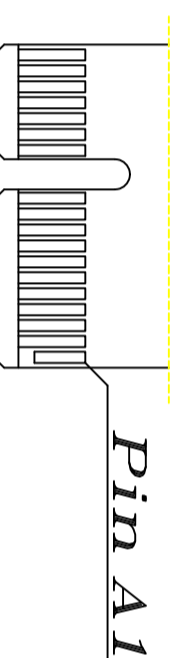
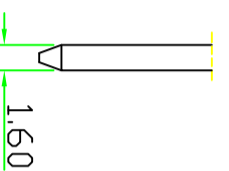
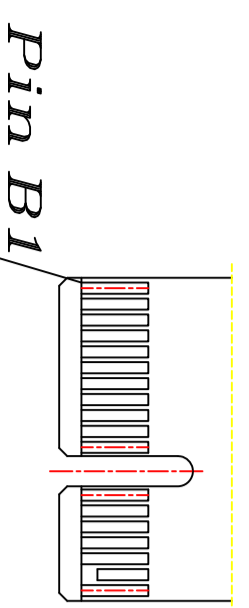

No Copper

No components

Primary
(Component)
Side

金手指, FR4材質, PCB
板厚 1.6mm

Secondary
(Solder)
Side

APPROVED:	- TOLERANCES -		UNIT:	TITLE :	SHEET
ENGINEER:	General	Angles	mm	Mini PCI-E to PCI-E Adapter	1/1
CHECKED:	30~ ±0.25	0° ±3°	SCALE:	DRAWING NUMBER:	SIZE
DRAWN:	10~30 ±0.20	0.0° ±2°	1:1	A-G-PE-PCBL	A4
	5~10 ±0.15			Date	REV.
	0~5 ±0.10			2008/August/4th	A/0

